

Updated information on the possible presence of a crack on one of the steel chain links of the Petzl ZIGZAG and ZILLON



November 3, 2014: this message follows the July 23, 2014 communiqué



Facts:

- Several ZIGZAGs with cracked friction chain links have been returned to Petzl.
- The worldwide return rate remains below 4/1000, but may be higher in some countries.
- **No incidents or accidents have been reported to us.**
- Both ZIGZAG and ZILLON friction chain links are affected.
- When a crack appears, it is always on the same side of the friction chain links.
- All devices returned to us with a cracked link have been replaced under warranty.

Petzl technical analysis:

Petzl has identified the root causes for the appearance of these cracks. These cracks are the result of a combination of three parameters:

- Riveting parameters on one side that create a potential residual tensile stress in the friction chain link.
- The small cross section of the link near the rivet position.
- Heat treatment that results in the cross section being too rigid.

Due to the combination of these three parameters:

- A crack can appear over time. The gradual appearance of these cracks makes them undetectable during final factory inspection.
- Only a very low percentage of ZIGZAG/ZILLONs may potentially develop such a crack.

Updated information on the possible presence of a crack on one of the steel chain links of the Petzl ZIGZAG and ZILLON



November 3, 2014: this message follows the July 23, 2014 communiqué

Technical changes already in progress for the friction chain of the Petzl ZIGZAG and ZILLON:

- Adjustment of the riveting parameters for the link assembly to eliminate residual tensile stress in the link.
- Adjustment of heat treatment parameters for the link to reduce rigidity of the material.
- Reinforcement of the small cross section of the affected links.

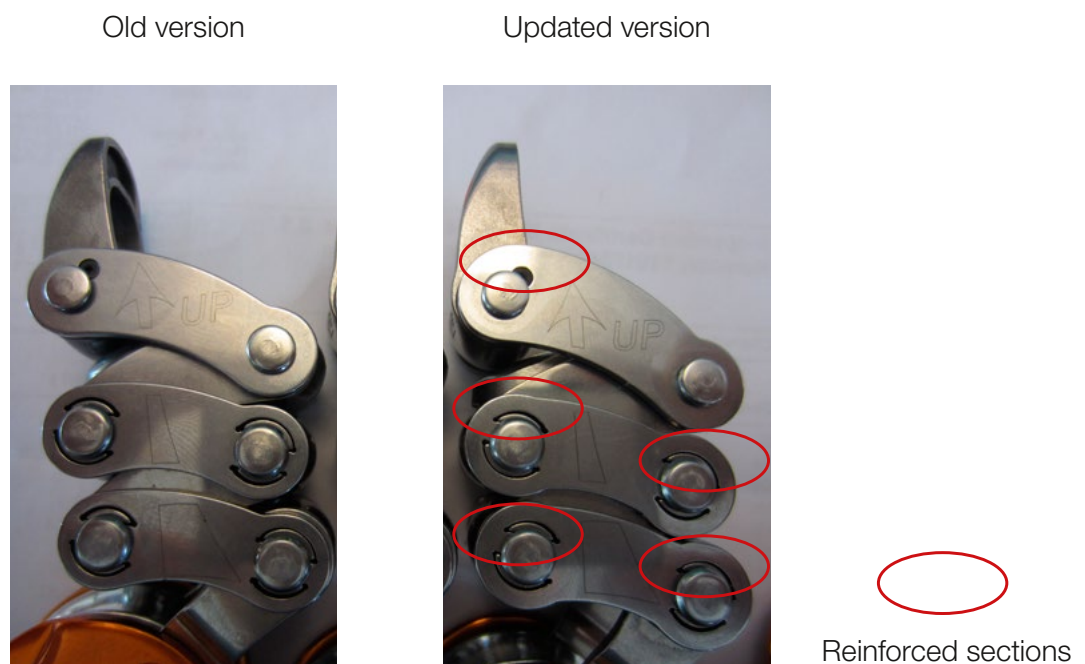

Petzl decisions and recommendations for ZIGZAG and ZILLON devices:

- A cracked link presents no additional immediate risk to the user. However, as with any personal protective equipment (PPE), the presence of such a crack requires immediate retirement of the device.
- Considering the very low rates of potentially cracked links, and taking into consideration that a cracked link presents no additional immediate risk to the user, only cracked devices will be replaced.
- The replacement of a cracked device will be done under warranty. The warranty for this defect has been extended to 10 years.
- Regularly inspect your device in accordance with the Petzl PPE checking procedure.
- In the unlikely event you find a cracked link, retire your device immediately and contact the Petzl distributor in your country.

The Petzl Team