

- In addition to routine checks for each use, PPE should regularly undergo a detailed inspection by a competent person. Petzl recommends an inspection every 12 months and after any exceptional event in the life of the product.
 - PPE inspection should be conducted with the manufacturer's Instructions for Use.
- Download the instructions at [PETZL.COM](https://www.petzl.com).

ASSISTED-BLOCKING BELAY DEVICES

1. Known product history

Any PPE showing questionable degradation should be quarantined, pending a detailed inspection.

The user should:

- Provide precise information on the usage conditions.
- Report any exceptional event regarding their PPE.
 (Examples: fall or fall arrest, use or storage at extreme temperatures, modification outside manufacturer's facilities).

2. Preliminary observations

Verify the presence and legibility of the serial number and the CE mark.

Note: the serial number code on our products is evolving. Two types of code will coexist. See below for details on each serial number code.

Code A:

00 000 AA 0000

Year of manufacture
 Day of manufacture
 Name of Inspector
 Incrementation

Code B:

00 A 0000000 000

Year of manufacture
 Month of manufacture
 Batch number
 Incrementation

Verify that the product lifespan has not been exceeded.

Compare with a new product to verify there are no modifications or missing parts.

Note: For the B coding, the month of manufacture is indicated by a letter. A corresponds to January, B to February, C to March, etc.

3. Checking the moving side plate

ALL BELAY DEVICES

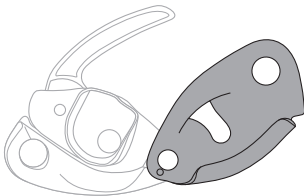

- Check the condition of the moving side plate (e.g. deformation, cracks, marks, wear, corrosion, dirt). If you see a hole in the side plate, retire the product.



- If applicable, check the condition of the wear plate.

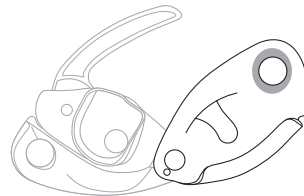

- Check the condition of the attachment hole (e.g. deformation, cracks, marks, wear, corrosion).

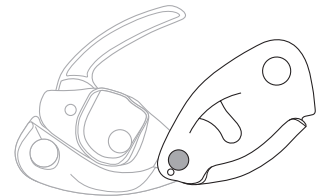

- Verify the presence and condition of the rivets (e.g. deformation, cracks, marks, wear, corrosion, lack of play).

4. Checking the condition of the frame

ALL BELAY DEVICES

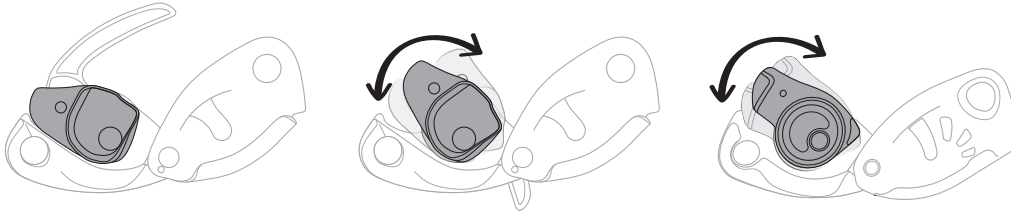

- Check the condition of the cam and its axle (e.g. deformation, cracks, marks, wear, corrosion, dirt). Check the mobility of the cam and the effectiveness of its spring.

NEOX

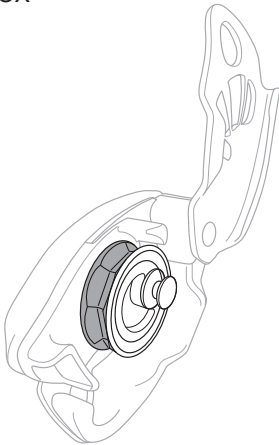

- On the NEOX, check the condition of the faceted wheel (e.g. deformation, cracks, marks, wear, corrosion, dirt).

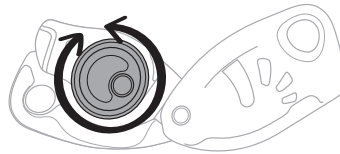

- Verify that the wheel rotates in both directions.

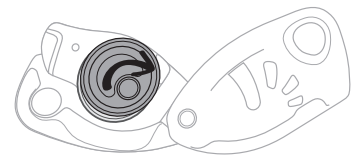

- Verify that the wheel moves upward, and check the effectiveness of the wheel's return spring.

ALL BELAY DEVICES

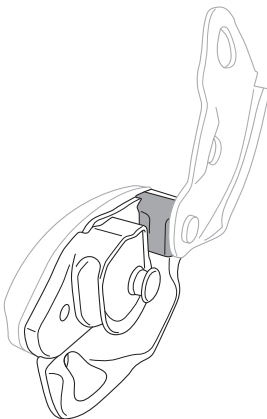

- Check the condition of the friction plate (e.g. deformation, cracks, marks, wear, corrosion, dirt).

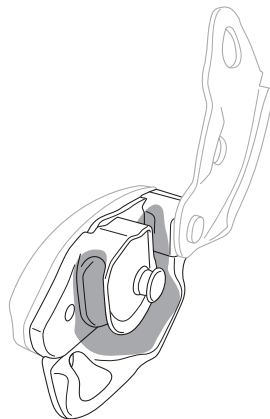

- Verify the absence of foreign objects (e.g. dirt) or lubricant on the rope path.

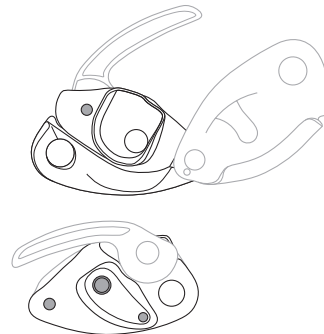

- Verify the presence and condition of the rivets (e.g. deformation, cracks, marks, wear, corrosion, lack of play).

5. Checking the condition of the handle

ALL BELAY DEVICES

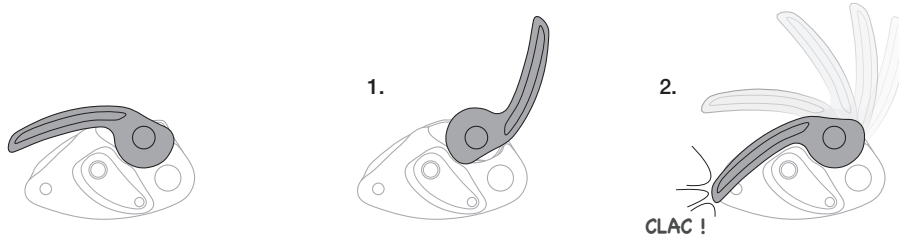

- Check the condition of the handle (e.g. deformation, cracks, marks, wear).
- Check that the handle return spring is working properly.

6. Checking the condition of the selector knob

GRIGRI +

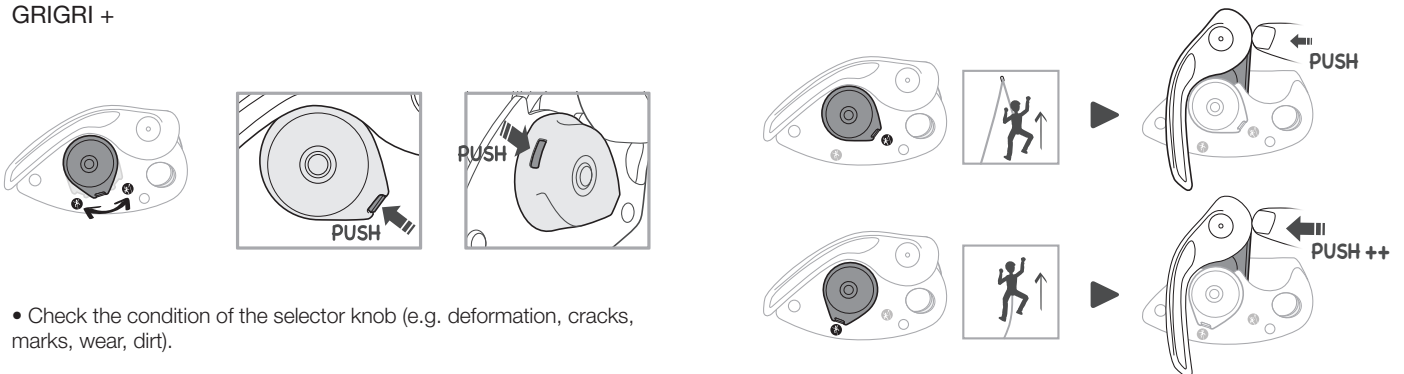

- Check the condition of the selector knob (e.g. deformation, cracks, marks, wear, dirt).

- Check both settings of the selector knob for proper function. When the cam is rotated, it must offer more resistance in the lead climbing setting than in the top-rope setting.

7. Function check

ALL BELAY DEVICES

- Carry out a function check with the device on the harness. Do this test with your smallest diameter rope.

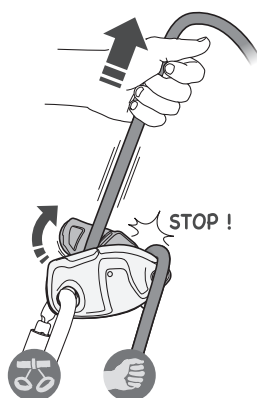

1. Pull on the climber side of the rope; the device should block the rope.

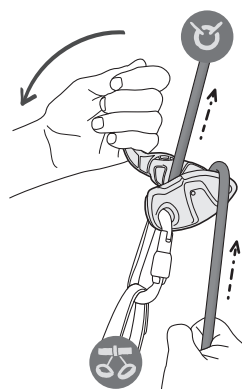

2. Hang from a low height. Pull the handle while holding the brake side of the rope. The rope must slide through the device.

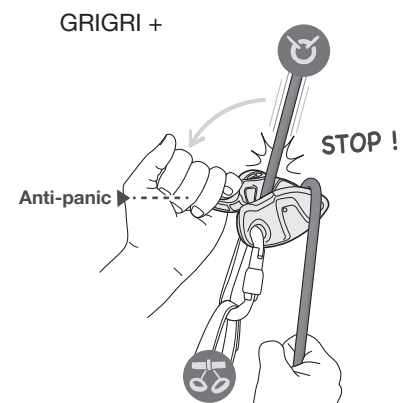

3. Checking the anti-panic on the GRIGRI +. Hang from a low height. Pull the handle QUICKLY while holding the brake side of the rope. The rope must be blocked.

8. Appendix: examples of GRIGRI that are worn, or that should be retired

- Bent GRIGRI

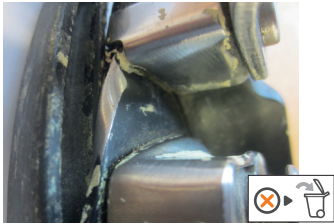

- Perforated moving side plate



- Bent handle



- Broken handle



- Worn-out rope path



- Broken handle



- Rope path

